

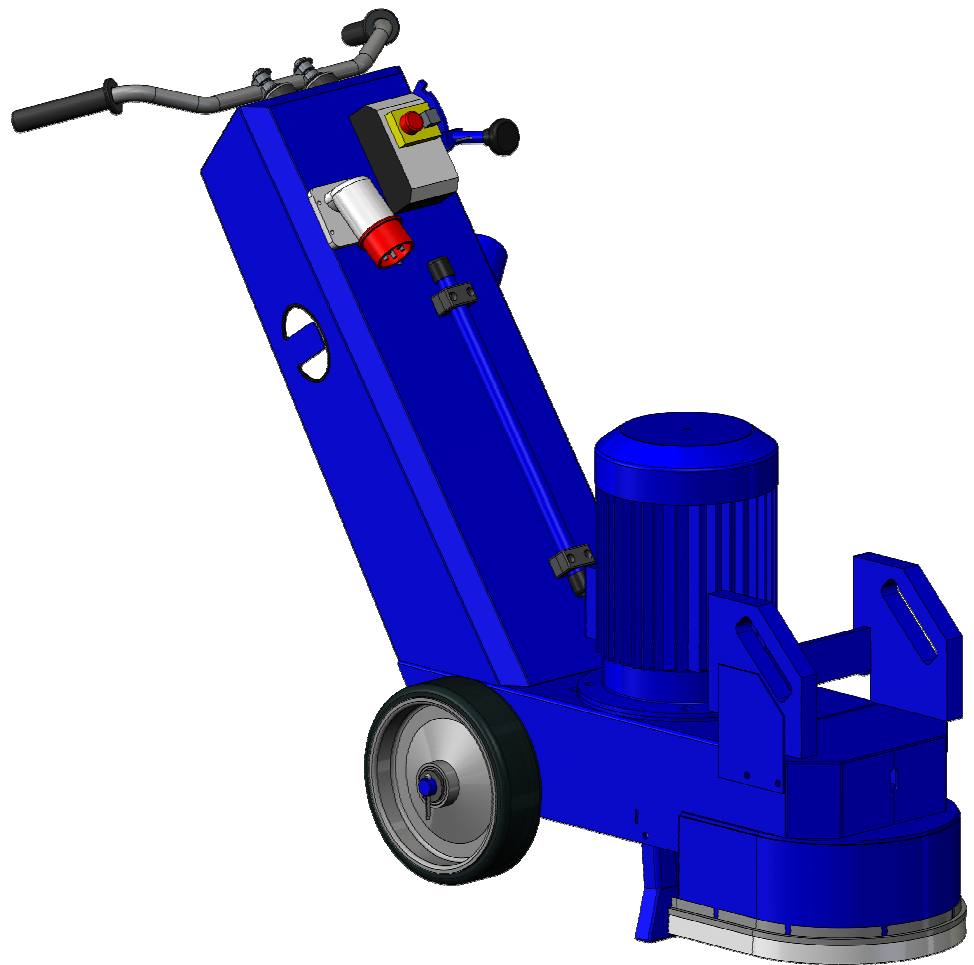

# **BG-250**

*Version 1.0*



**info@blastrac.eu**

**EC DECLARATION OF CONFORMITY**

in accordance with Appendix II sub A of Directive 98/37/EC

**BLASTRAC B.V.**

Utrechthaven 12  
NL - 3433 PN NIEUWEGEIN  
Tel: 0031 (0)30 601 88 66  
Fax: 0031 (0)30 601 83 33  
Info@Blastrac.nl  
The Netherlands

Declare under our sole responsibility that the machine as described below  
Conforms with the Health and Safety requirements of the European Directive  
of the machine Safety.

In case of changes to the machine without our written authorization this declaration loses  
its validity.

**Model:****BLASTRAC BG-250/0000****Serial number: xxxxB**

1. satisfies the conditions set out in the Machine Directive (Directive 98/37/EC); Low voltage directive (73/23/CEE, as last amended; EMC directive 89/336/CEE, as last amended)
2. satisfies the following harmonized standards:  
NEN-EN 349, NEN-EN 418, NEN-EN 294 and NEN-EN 60204

Nieuwegein 17-01-2005



Michiel Kalisvaart



[info@blastrac.eu](mailto:info@blastrac.eu)

## Table of contents

<b>EC Declaration of Conformity</b>	<b>02</b>
<b>1. Introduction</b>	<b>04</b>
<b>2. Machinedescription</b>	<b>04</b>
Application	
Accessory's	
<b>3. Safety</b>	<b>05</b>
Safety precautions	
Safety regulations	
Safety instructions	
<b>4. Initial operation</b>	<b>07</b>
Checkpoints of electrical safety	
Checkpoints of machine safety	
Removing the diamond disc	
Mounting the diamond disc	
<b>5. Operating</b>	<b>08</b>
Switch on the machine	
Switch off the machine	
Operating during grinding	
<b>6. Maintenance</b>	<b>09</b>
Replacing the flexible coupling	
<b>7. Technical data</b>	<b>10</b>
<b>Contact</b>	<b>11</b>

## 1. Introduction

It is important that all persons who are working or maintaining with this machine will read the manual carefully and understand it fully. Keep this manual near to the machine, so it can always be consulted.

Only authorized and trained personnel may operate this machine.

## 2. Machine description

The BG-250 is an electric driven floor grinding machine for treating horizontal surfaces. The machine has a rotating adapter plate where the diamond disc can be fixed on. The rotating parts are covered by a protection cap with a connection for a dust hose. With a suitable Blastrac dust collector you can work without causing dust.

### Application

The BG-250 can be used on almost any floor to plane, to make ready for coatings, or to remove coatings or glue residues.

1	Hand lever support	6	Driving motor	11	Diamond disc
2	Handgrip	7	Add on weight	12	Brush seal
3	On / Off emergency switch	8	Grease nipple	13	Support
4	Socket with phase inverter	9	Bearing unit	14	Wheel
5	Dusthose connection	10	Flexible coupling	15	Strain relief

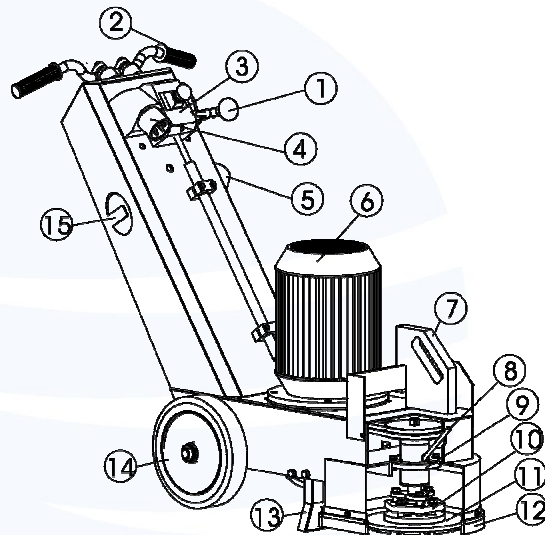

### Accessory's

There are several types of discs that may be used on this machine.

The discs that can be used are:

B21792LH	Diamond disc 250mm soft Red
B21793LH	Diamond disc 250mm middle Green
B21794LH	Diamond disc 250mm hard Blue

[info@blastrac.eu](mailto:info@blastrac.eu)

### **3. Safety**

Before operating the machine, the personnel must be familiar with the safety instructions given in this manual.

Keep this manual near to the machine, so it can always be consulted.

#### **Safety precautions**

- The surface to be treated must be swept clean to remove stones, screws etc.
- Never use the machine when the surface is not clear and if there is a risk of tripping.
- Make sure there is not any water on the surface to be treated.
- Remove any trailing electrical cables and or dust hoses from the surface to be treated
- Always use a dust collector
- Don't get disturbed during the activities.

#### **Safety regulations**

- Persons who are not operating the machine must not be permitted to stay in the surrounding area of the machine.
- Don't change anything on the machine. Use always cables which are approved and safety earthed (extend) cables. The machine is always equipped with an earthed connection, do not change this and use always earthed cables with an earthed plug.
- Connect main power supply cable to an installation with an earth leakage circuit breaker.
- Inspect and test the electrical components regularly. The electrical components have to satisfy to the requirements which apply to these components.
- Always call a skilled electrician or your distributor when you have questions about the safety of the electrical components.
- Work on electrical equipment or operating materials may only be undertaken by a skilled electrician or by trained persons under the guidance and supervision of a skilled electrician as well as in accordance with the electrical engineering regulations.
- Pull out the main plug during inspections and repairings on the machine.
- Never operate the machine when the surface is wet.
- Never use the machine in the rain.
- The machine contains rotating parts, so always leave the diamond disc on the floor while the motor is turning.
- The flexible coupling can become obsolete with use, because of this there can be higher vibrations than normal. Check for this reason regularly the flexible coupling.

**[info@blastrac.eu](mailto:info@blastrac.eu)**

The following sticker is placed on the machine.



Meanings of these symbols are:

- Ear protection is obliged
- Safety glasses with lateral protection are obliged
- CE-mark on this machine
- Safety shoes obliged
- Consult the manual before operating the machine

Personnel must tie back long hair and not wear loose clothing or jewellery including rings. Wear gloves and dust mask during operating the machine.

### **Safety instructions**

- Do not stand the machine on the diamond disc or coupling when it is not in use, this will cause deformation to the flexible coupling. Put the machine always on the support which is made for this reason.
- Make sure the machine is clean and that the handgrips are dry and free of grease and oil.
- Make sure the brush seals are in good condition, this to avoid dust.
- Pull out the main plug when changing the disc or flexible coupling.
- It is not allowed to lift the machine without use of appropriate appliances as a lift or crane.
- Lift the machine up like it is shown in the picture below by point 2.

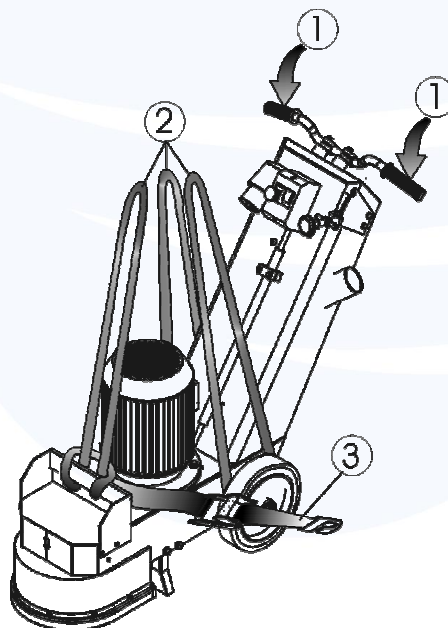

**info@blastrac.eu**

## 4. Initial operation

Before using the machine it is committed to inspect the machine. It is not permitted to use the machine if the machine safety is not according to the checkpoints below.

### Checkpoints for electrical safety

- Use only extension cables for extending the main cable that are sized and marked in accordance with the overall power consumption of the machine.
- Electrical cables must be rolled entirely off of the reels.
- Any damage to electric cables is not permitted
- Use an electrical power supply connection with earth connection

### Checkpoints of machine safety

Check if:

- The safety functions and operating functions work correct.
- The flexible coupling is not deformed or damaged
- The diamond disc is not damaged
- There are no damages on the electrical components.
- There are not any loose nuts or bolts
- There is no damage to the dust hose and if it is connected well.

### Removing the diamond disc

- Make sure the power supply plug is out of the machine
- Lay down the machine so it is lying on the handle. Make sure the machine will not fall back down. A second person can stand on the handle to make sure it will not fall back down.
- Loosen the 4 bolts with an appropriate key.
- Remove the diamond or multiflail disc.

### Mounting the diamond disc

- Make sure the power supply plug is out of the machine.
- Lay down the machine so it is lying on the handle. Make sure the machine will not fall back down. A second person can stand on the handle to make sure it will not fall back down.
- Fix the diamond or multiflail disc underneath the adapter plate and turn the 4 bolts with an appropriate key tight.

[info@blastrac.eu](mailto:info@blastrac.eu)

## 5. Operating

During operating the BG-250, the following additional safety instructions must be followed closely.

### Switch on the machine

- Turn on the dust collector before switching on the machine.
- Connect the dust hose with the machine
- Stand behind the machine
- Make sure that the machine stands on the support.
- Push the start button (2) on the electrical box.
- Check if the machine turns the right direction.
- If not, turn the phase inverter in the socket and start the machine again.
- Let down the machine till the diamond disc hits the floor
- Start grinding

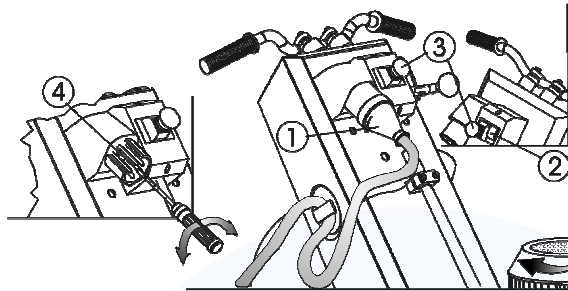

### Switch off the machine

- Push the red button (3) on the electrical box
- Wait until the machine stops rotating before you set the machine on the support.
- Pull out the power supply
- Shut down the dust collector.

### Operating during grinding

To get an optimum result during grinding, the machine may not stand still. The machine must always be in movement so it does not grind too deep into the floor. Move the machine from left to right and from forward to backwards to get a nice flat result.

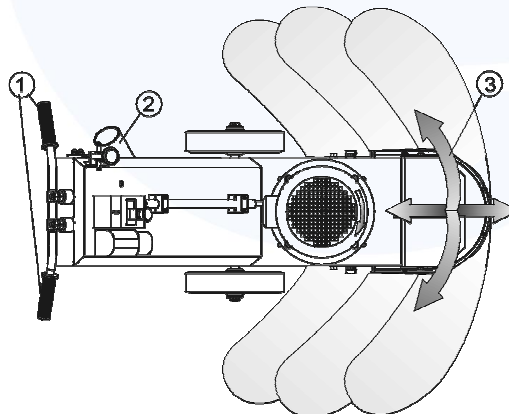

[info@blastrac.eu](mailto:info@blastrac.eu)



## 6. Maintenance

Work only with original Blastrac parts.

Check regularly to see if the diamond disc is in good condition. Replace immediately the diamond disc when this is damaged or worn out.

Check if the flexible coupling is stiff enough, after every 2 diamond disc changes. Replace if any deformation or damage is found, replace the coupling after use of 7 diamond discs. Unusual vibrations on the machine check immediately the diamond disc and flexible coupling

### Replacing the flexible coupling:

- Pull out the main plug
- Remove the diamond disc
- Remove the brush seal
- Loose the bolts of the adapter plate and the flexible coupling
- Take a new flexible coupling and assemble this together with the adapter plate on the fixed coupling on the motor axle
- Assemble the brush seal.

Prevent premature wear by keeping the machine as dust free as possible. Clean the machine for this reason regularly with a dust collector

Clean the machine every day with air and non-aggressive materials. Never use a high pressure water cleaner to clean the machine.

Remove the diamond disc after using the machine

Store the cleaned and dry machine in a dry and humid free room. Protect the electrical motor from moisture, heat, dust and shocks.

All repair work must to be done by qualified Blastrac personnel, this to guarantee a safe and reliable machine.

Any guarantee on the machine is expired when:

- Non original Blastrac parts and diamond discs have been used
- Repair work is not done by qualified Blastrac personnel
- Changes, add on 's or conversions are undertaken without written permission of Blastrac BV

**info@blastrac.eu**

## 7. Technical data

	<b>BG-250</b>
Power consumption	5,5 kW
Electrical connection	400V / 50 Hz
Diameter diamond disc	Ø 250 mm
Working width	250 mm
Rotation speed	2000 min <sup>-1</sup>
Length	1250 mm
Width	620 mm
Height	1020 mm
Weight	105 kg
Noise level	78dB(A)
Dust hose connection	75 mm Ø
Suitable filter unit	Contact Blastrac BV We will assist you with a good advice

Design and specifications are subject to change without notice by Blastrac BV

[info@blastrac.eu](mailto:info@blastrac.eu)

**HEADQUARTER**

*Blastrac BV The Netherlands  
Utrechthaven 12  
NL - 3433 PN Nieuwegein  
Tel: 0031 (0)30 601 88 66  
Fax: 0031 (0)30 601 83 33  
info@blastrac.nl*

*Blastrac United Kingdom  
Unit 2, Outgang Lane, Dinnington  
Sheffield, South Yorkshire  
GB - S25 3QU, England  
Tel: 0044 (0) 1909 569 118  
Fax: 0044 (0) 1909 567 570  
info@blastrac.co.uk*

*Blastrac France  
ZI  
29, Avenue des Temps Modernes  
F - 86360 Chasseneuil du Poitou  
Tel: 0033 (0)5 49 00 49 20  
Fax: 0033 (0)5 49 00 49 21  
info@blastrac.fr*

*Blastrac Spain  
Calle Copernico, 16  
Nave 2  
E - 28820 Coslada  
Tel: 0034 91 660 10 65  
Fax: 0034 91 672 72 11  
info@blastrac.com.es*

*Blastrac Germany  
Mathias Brügggen Straße 144  
D - 50829 Köln (Ossendorf)  
Tel: 0049 (0) 221 70 90 32 0  
Fax: 0049 (0) 221 70 90 32 22  
info@blastrac.de*

*Blastrac Poland  
Golina, Dworcowa 47a  
63-200 Jarocin  
Tel: 0048 62 740 40 27  
Fax: 0048 62 740 40 27  
info@blastrac.pl*

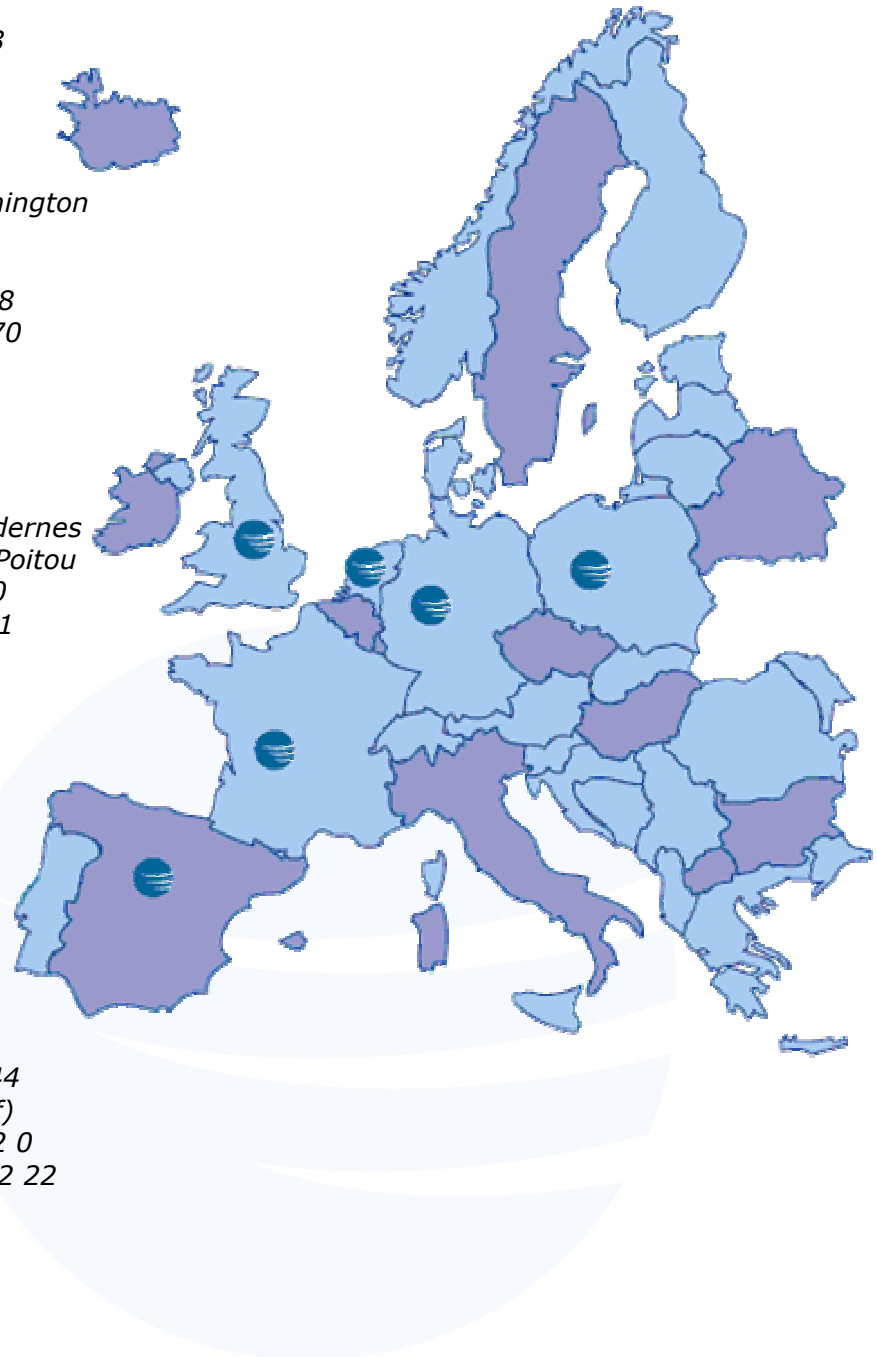
**info@blastrac.eu**